

Architectural LED NEO-FLEX STRIP

Model: FC120M30-10M-24V-X (X = COLOR Warm White, Cool White, Red, Green, Blue, Yellow)

LED WORLD
ledworldlighting.com | ledworld.ca
1-800-387-4081



Only power with 24VDC
Class 2 Power Source

IMPORTANT INSTRUCTIONS

Please read instructions before using product and **SAVE THESE INSTRUCTIONS**. Before using this product make sure you have right color, product (item number) and voltage (printed on product). Check for possibility of damage during shipping. If damaged, or wrong product, do not use. Disconnect power before installing or using.

Use only with Class 2 Type power supply. Using with any other type of power supply will void the limited warranty.

Use only with LED World's Class 2 Type power supply.

For wet location installations, seal all possible water entry points and covers using silicone

Disconnect power before installing or servicing (at breaker point).

This product is intended to be installed and serviced by a qualified licensed electrician. Install in accordance with the National Electric Code, and local regulations. Only power with a (listed) constant voltage Class 2 power supply (24V DC).

Never plug into 120V AC. The product requires a optional class 2 Transformer.

Ensure the overall length of the neonflex does not exceed the maximum run length as 15m one end powered; 30m two ends powered.



Cutmark

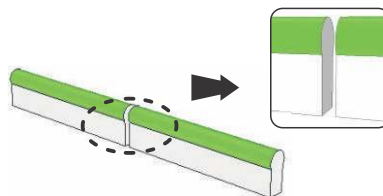

Cutting has to be straight

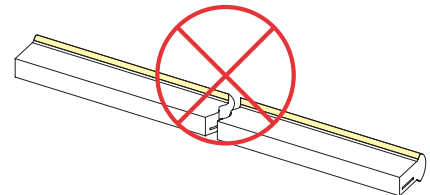

No cut distortion

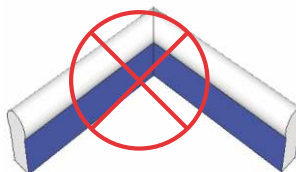
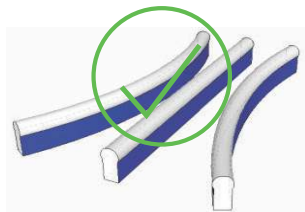

Do not bend 90°

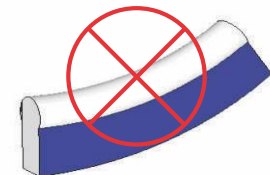

Do not bend Horizontally

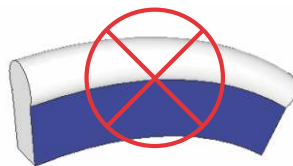

Do not bend Horizontally

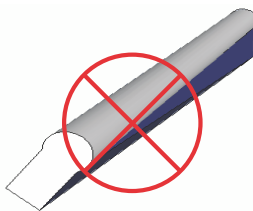

Do not Twist

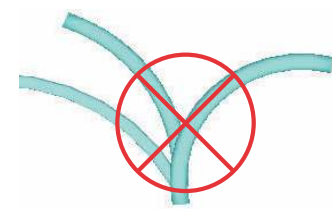

Do not bend repeatedly

FIVE YEAR LIMITED LIGHTING WARRANTY

LED WORLD INC. warrants this product for five year (some exceptions may apply) from the date of shipping unless otherwise noted in writing. This warranty is expressly in lieu of all other warranties expressed or implied. Under this Limited Warranty, the obligation of the company is limited to replacing on a prorated basis, at its option, any component found to be defective. This Limited Warranty does not apply to damage caused by buyer or alteration to the product or incorrect power supply. Factory warranties are covered by the original manufacturer and claims must be submitted to them. This product must be used with LED World's class 2 power supply. Failure to do so will void limited warranty.

LED World Inc. And its providers will never be liable to you or any other person for any indirect, incidental, consequential, special, punitive or exemplary loss or damage arising from, connected with, the purchase of products, including but not limited to loss of data, business, markets, cost of labour, savings, income, profits, use, production, reputation or goodwill, anticipated or otherwise, or economic loss, under any theory of liability (whether in contract, tort, strict liability or any other theory or law or equity), regardless of any negligence or other fault or wrongdoing (including without limitation gross negligence and fundamental breach) by led world inc or any person for whom led world inc is responsible, and even if led world inc has been advised of the possibility of such loss or damage being incurred.

If a product is defective, we will replace the product with similar or identical product or at our option a credit towards a future purchase. To make a claim under this warranty, obtain a return authorization number.

Architectural LED NEO-FLEX STRIP

Model: FC120M30-10M-24V-X (X = COLOR Warm White, Cool White, Red, Green, Blue, Yellow)

TOOLS REQUIRED



Cutter



RTV 108 Type silicone glue

MOUNT STRIP INTO ALUMINUM CHANNEL/MOUNTING CLIP

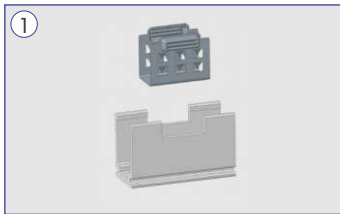

Mounting clip comes with self-lock bracket

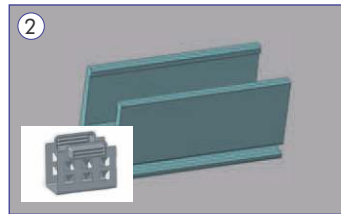

Aluminum channel comes with self-lock bracket



Place the self-locking bracket into the strip

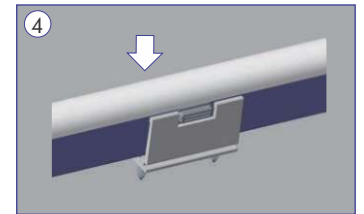

Push strip into Mounting clip/Aluminium channel

CONNECTING TWO STRIP WITH INTERCONNECTION CONNECTOR (N24-ICSF)



Connecting with interconnection connector

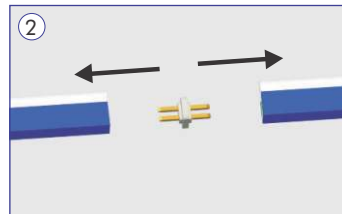

Insert pin into the strip

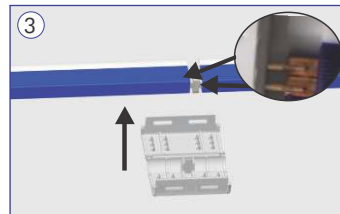

Glue at joint and housing

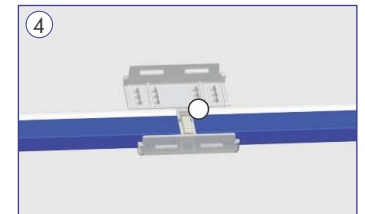

Close the housing

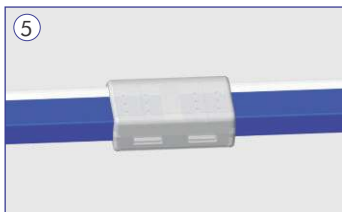

Final result

Architectural LED NEO-FLEX STRIP

Model: FC120M30-10M-24V-X (X = COLOR Warm White, Cool White, Red, Green, Blue, Yellow)

CONNECTING TWO STRIP WITH L INTERCONNECTION CONNECTOR (N24-LCS)

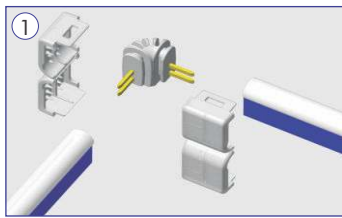

Connecting with L interconnection connector (N24-LCS)

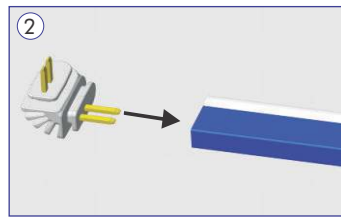

Insert pin into the strip

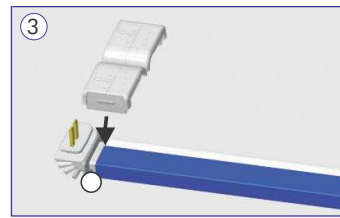

Glue at joint and housing, then put the strip back to housing

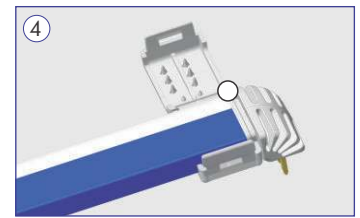

Close the housing

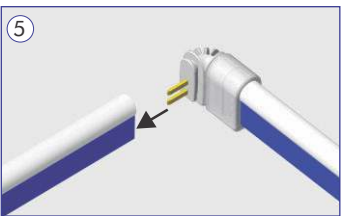

Insert remaining pin into the strip

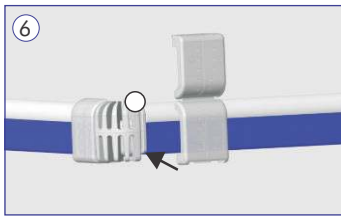

Glue at joint and housing, then put the strip back to housing

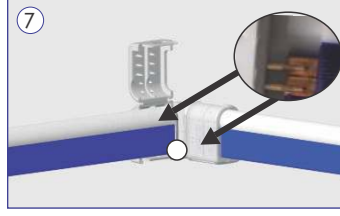

Close the housing

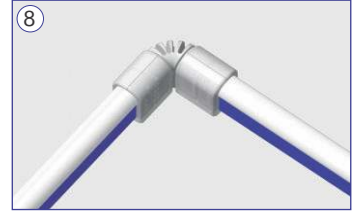

Final result

CONNECTING STRIP WITH POWER SUPPLY CONNECTOR (N24-PCI/N24-PCR)

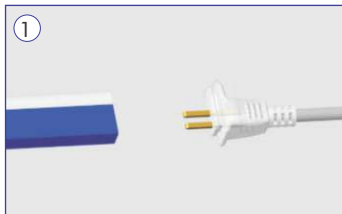

Connecting with power supply connector (N24-PCI/N24-PCR)

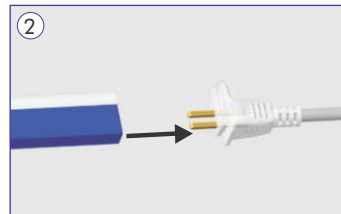

Insert pin into the strip

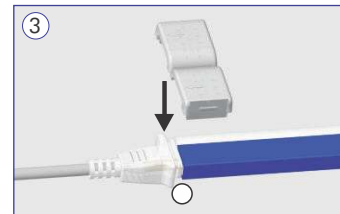

Glue at joint and housing

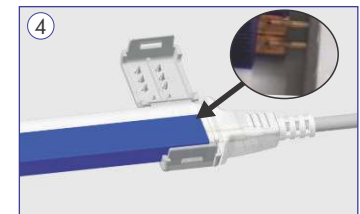

Close the housing

IMPORTANT INSTRUCTIONS

TROUBLESHOOTING

Tape light strip does not light

- Make sure your power supply is turned on and has the correct voltage.
- Have a electrician check all connections from the power supply to the LED Light Strips.
- Consider testing with a multimeter to ensure light strip is receiving 24V power.

LED Flex Strip lights blink on, then go off

- The power supply is not adequate for the length of LED Light Strips you are powering. Install a adequate Class 2 power supply.

LEDs farthest from the power supply are noticeably dimmer

- This is the result of voltage drop. Decrease the length of the 24V power feed or use thicker power feed wires between the 24V power supply and the lighting strips.

MAXIMUM FLEXSTRIP LENGTH SUPPORTED BY LED WORLD'S CLASS 2 POWER SUPPLY

Power Supply	Max Feet of LED Flexstrips	Power Supply	Max Feet of LED Flexstrips
 CVN96L24DC	33.4 Feet (Continuous 77 Watts)	 XLD200B-224V-FC	2 X 34.8 Feet (Each Channel) Total 69.6 Feet